



DELFIN
CRUISE THE *Amazon*

DELFIN AMAZON CRUISES
EXPEDITION CRUISING
UPPER AMAZON, PERU

 **RELAIS & CHATEAUX**



“When changing the way you look at the world is one of your travel goals, when authenticity matters more than the ordinary, experience the Amazon Rainforest in style because we have taken personalized boutique travel and services one step beyond the expected.

Once you travel with us, your perspectives will change forever.”

ALDO MACCHIAVELLO & LISSY
URTEAGA

A PERSONAL **DREAM**

Delfin Amazon Cruises was launched in early 2006 by its founder and CEO, Aldo Macchiavello. The company is the culmination of a dream shared with his wife Lissy Urteaga: run a boutique travel business for sophisticated travelers in their amazing country, Peru.

ALDO & LISSY are fully dedicated to personally running the business armed with extensive international travel experience and a taste for casual yet refined travel. Aldo, a graduate of Purdue University's Krannert Graduate School of Management and with 25 years in the banking sector, has in-depth knowledge of Peru and a passion for tourism. He brings to the business a unique combination of professionalism and vision. Lissy is blessed with unlimited creativity, imagination for details and a natural ability to make guests feel at home. With a background in art and interior design, she adds just the right combination of exclusivity and charm.

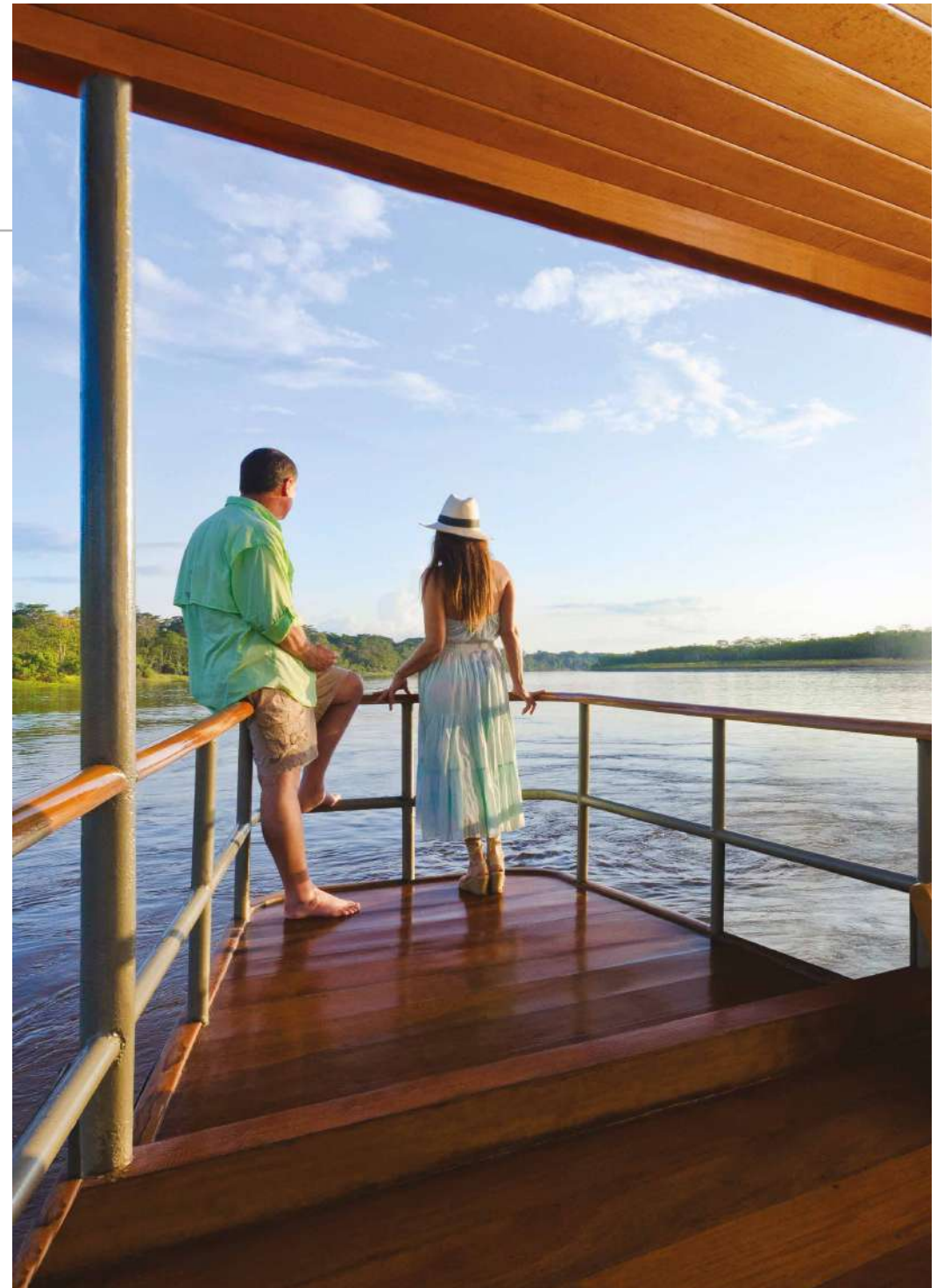

THE AMAZON

rainforest is named after the Amazon River, the life force of the jungle. It is a unique ecosystem that harbors 1/3 of all living species in the world! The total extent of this incomparable tropical jungle is estimated in comparison to the complete land area of the United States. 28 billion gallons of its waters flow into the Atlantic every minute, diluting the salinity of the ocean for more than 100 miles offshore. The Amazon watershed is home to the world's highest biodiversity, with more species of plants and animals than any other terrestrial ecosystem on the planet. Its range is so astounding that scientists continue to regularly discover new species of flora and fauna.

THE PACAYA SAMIRIA

National Reserve is the second largest national reserve in Peru, spanning more than 5 million acres. Known also as the mirror forest, it is the largest protected flooded forest in the world, making it one of the prime intact swaths of rainforest in the Peruvian Amazon. During the rainy season in the Andes, the water level rises, flooding 85% of the reserve and making it only accessible by boat. It is like no other protected area in Peru and its directly linked to the economic well-being of a large native resident population. At least 100,000 Ribereños - people living along its riverbanks - rely on its aquatic and terrestrial resources for food and income.





Our vessels thrive in splendid harmony with nature and its spectacular surroundings, and our guests appreciate the “noncruise” atmosphere and the sense that you are on board to explore one of the world’s most intriguing environments.

We set the highest standards for impeccable service, unique style and superb cuisine. Our vessels take you one step beyond luxury, where comfort and grace combine effortlessly with the wilderness of the Amazon in a setting of understated elegance and world-class hospitality.



THE **DELFIN I**

is the most exclusive vessel that sails in the Peruvian Amazon region, offering just 4 exclusive oversized suites with panoramic private terraces; 2 of these offer a private whirlpool for the ultimate treat.

Travelers will be spoiled by the floor-to-ceiling windows that allow nature to be part of the natural suite décor. 3 times daily cabin service will ensure you the most optimal personalized service possible.

On the top deck, guests will find a lounge area, bar and entertainment center which are perfect places to relax in, while the jungle unfolds before their eyes.

Of course, not all time is spent onboard. On the Delfin I, guests can get out on the water with the kayaks and our new stand up paddleboards.



Delfin I: Deluxe Master Suite with Plunge Pool





THE DELFIN II

is our Expedition Cruise vessel launched in March 2009 with 14 oversized suites: 4 master suites and 10 suites. Each with movie screen sized windows and natural elements, they offer all the comforts provided by world class lodging yet with the spirit of casual and refined elegance.

The dining room, observation deck and lounge, bar, entertainment center, and library are the ideal gathering places for all our guests.

To compliment your daily excursions in the rainforest, we welcome you to enrich your body while on board by making use of our newly restored exercise space. Whether you enjoy aerobic exercises or cardio, our gym resources are available at your disposal. Better yet, the floor to ceiling window allows so you never miss a second of the vibrant jungle scenery outside.

Wellness and healing continues with our spa services. Surrounded by the lush natural surroundings of the Amazon, we encourage you to dive into the benefits of rainforest remedial philosophies and therapies.

Finally, we welcome you to our lovely enclosed lecture room and lounge, which was warmly designed and carefully supervised by owner Lissy Urteaga. It is a great space to read a book, play boardgames, and relax. The room is equipped with a full set of media equipment and print materials as well so you can learn more about the wonderful Peruvian Amazon.



Delfin II: Master Suite



Delfin II: Dining Room



THE **DELFIN III**

is our newest vessel, offers guests an immersive rainforest experience while simultaneously treating them to the highest levels of luxury. Launched in 2015 is also the largest in our fleet, with capacity for up to 44 guests. The ship has been beautifully finished with the finest details, hardwood floors, designer furniture, and handmade Peruvian art and crafts. The itineraries have been carefully planned and are set to offer an unforgettable experience. Guests will have no shortage of up close rainforest experience and gourmet food to complement.

Guests have the option of four room settings. On the first deck there are 8 Suites with floor to ceiling panoramic windows as well as 2 spacious Corner Suites facing the front of the ship. On the second deck you'll find 10 Upper Suites and the largest of all, the Owner's Suite. The top deck features beautiful indoor and outdoor lounge, a sundeck with plunge pool, a spa and gym, and of course the bar.



Delfin III: Owner Suite



Delfin III: Sun Deck

MEMORABLE **DINING**

goes hand in hand with a Delfin experience. Peruvian cuisine is considered one of the world's finest and reflects the country's intrinsic cultural diversity.

Welcome to our gastronomic adventure where our dedicated staff pride themselves on carefully preparing contemporary Creole plates and offer exceptional service for your ultimate indulgence.

The Amazon's wild choices of fresh ingredients and the gentle blend of worldly immigrant traditions will enchant your taste buds.

Handmade plate ware, locally made table decorations changing from meal to meal and instrumental music performed by our staff create the ambiance to make each meal an unforgettable experience.







THE CREW

of the Delfin I, Delfin II and Delfin III is one of our deepest prides. Our standards are high. Once you travel with us, your expectations will be forever changed. Our guides, skippers, chefs and crew members - many of them native Amazonians - are experienced and trained professionals as well as charming travel companions. With a high ratio of crew for every passenger, they provide our guests personal and undivided attention.

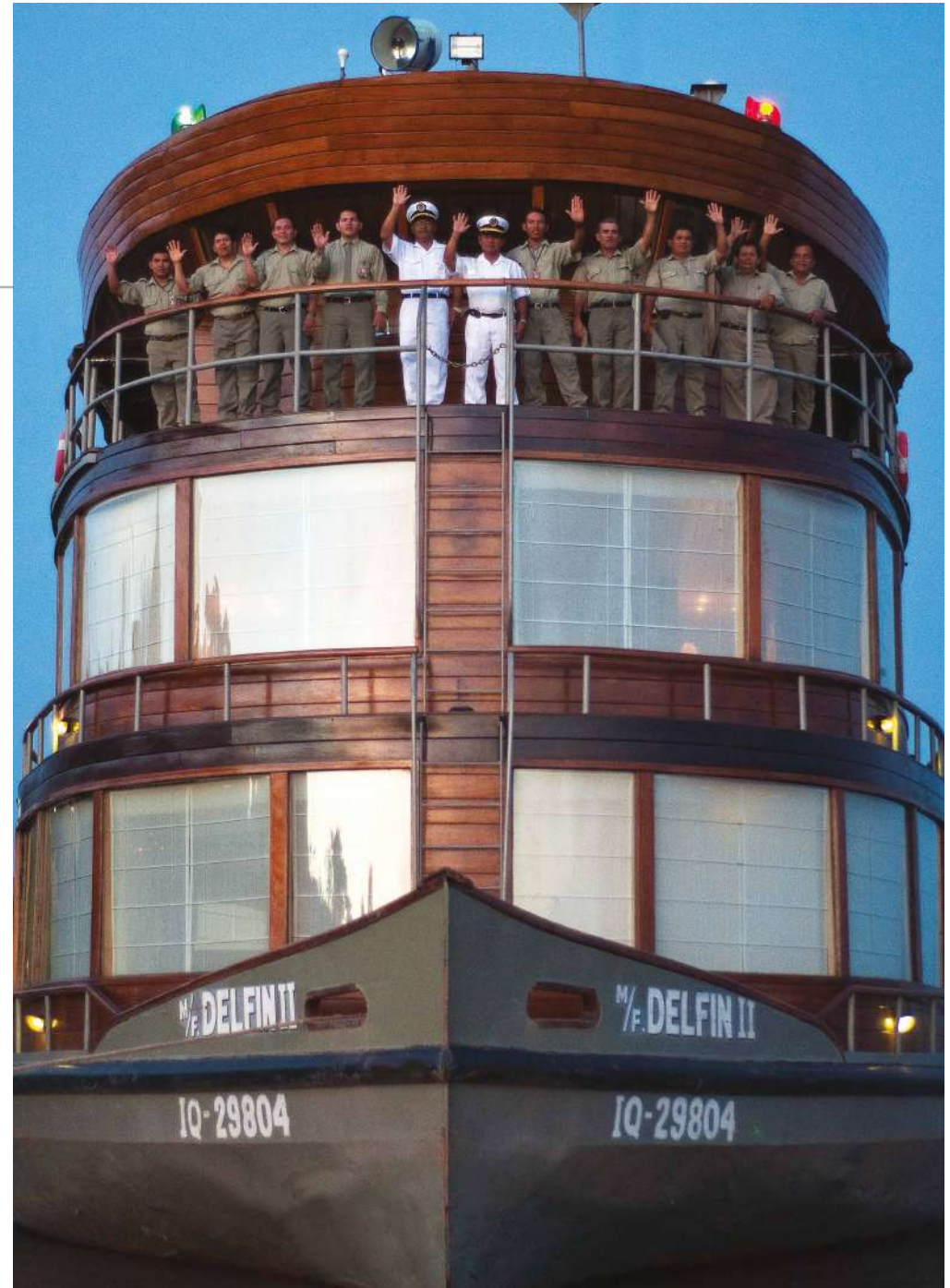



ACTIVITIES

Delfin Amazon Cruises match your destination, itinerary, and travel dreams in the Amazon. Your expedition cruising journey takes off on arrival in Iquitos where we will personally pick you up and take you to our vessel. There, you will experience an ideal combination of natural wonders, dramatic scenery, indigenous cultural history, and a relaxed and self-contained way to explore the Amazon, all while sightseeing nature at its best.

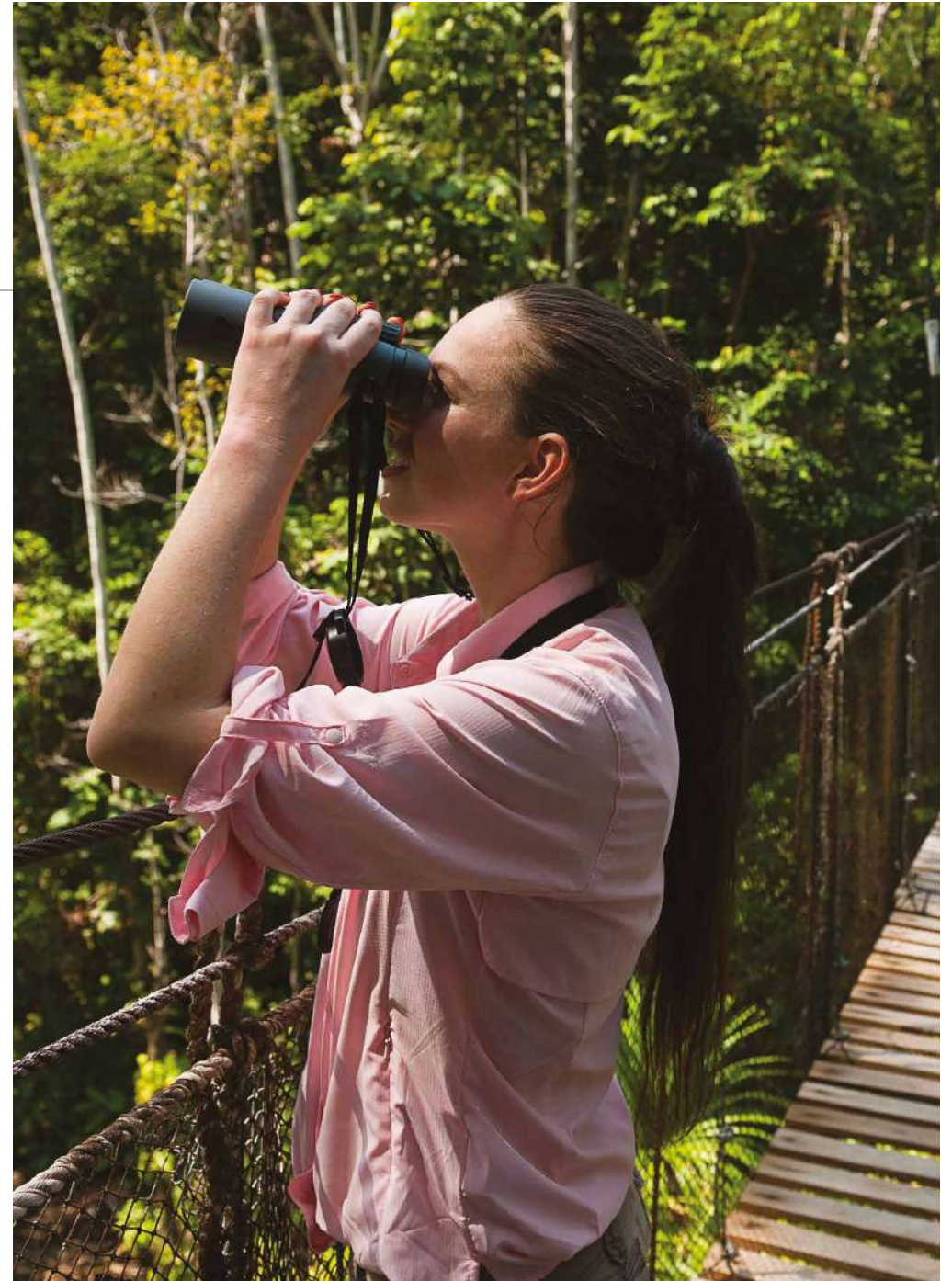





Kayaking



Piranha Fishing



Birdwatching



UNPARALLELED **BIODIVERSITY**

Is key in the Amazon Jungle, the largest track of tropics in the Americas and the world. 1/3 of all species recorded in the world are found in the Amazon Basin. One in five birds on earth lives in this extraordinary habitat. The largest collection of living plants and animal species will be find here and is estimated that many thousand of species are yet to be discovered. Among the most mysterious are the pink and grey river dolphins that will be found in many tributaries and lakes.





COMMUNITIES

The people in the Amazon have lived in the rainforest for thousands of years and their lifestyles and cultures are well adapted to and integrated with this rich environment.

Contrary to popular belief, their daily living does not significantly harm their home environment. Their work day is mostly occupied by subsistence activities such as fishing, small-scale agriculture, gathering and hunting. Their survival depends on their intimate relationship with their natural surroundings.





CRUISES

Our goal is to provide the highest level of service possible and to create a memorable, unparalleled experience in one of the world's last frontiers. Your Amazon journey takes off on arrival in Iquitos in the northern Peruvian jungle. After a 1.5 hour flight from Lima, we will pick you up at the airport in the afternoon and take you to our private embarkation port in Nauta (1.5 hours south of Iquitos airport) where your adventure experiencing exuberance, dramatic scenery and wilderness begins.

Delfin I:

3 nights: departs on Mondays
4 nights: departs on Thursdays

Delfin II:

3 nights: departs on Sundays
4 nights: departs on Wednesdays

Delfin III:

3 nights: departs on Saturdays
4 nights: departs on Tuesdays

TAILOR-MADE CHARTERS allow us to personalize your Amazon voyage. In addition to our regular itineraries, we can create a unique, fully custom-designed program just for you and your loved ones. Bird watching, professional fishing, and deep exploration of jungle trails are just some examples of specialized daily excursions we can arrange for your specific group's interests, skills, and sense of adventure.

SEASONS:

At the Pacaya Samiria National Reserve, there are 2 main seasons:

High water season: November to May. Ideal for the Senior traveler or photographers that prefers to go further into the reserve onboard speed boats to see the landscapes and wildlife.

Low water season: June to October. Ideal for the Active traveler that prefers to walk through the rainforest and discover its flora and fauna, summer close.



DECK PLAN DELFIN I

TOP OBSERVATION DECK



UPPER DECK
Cabins

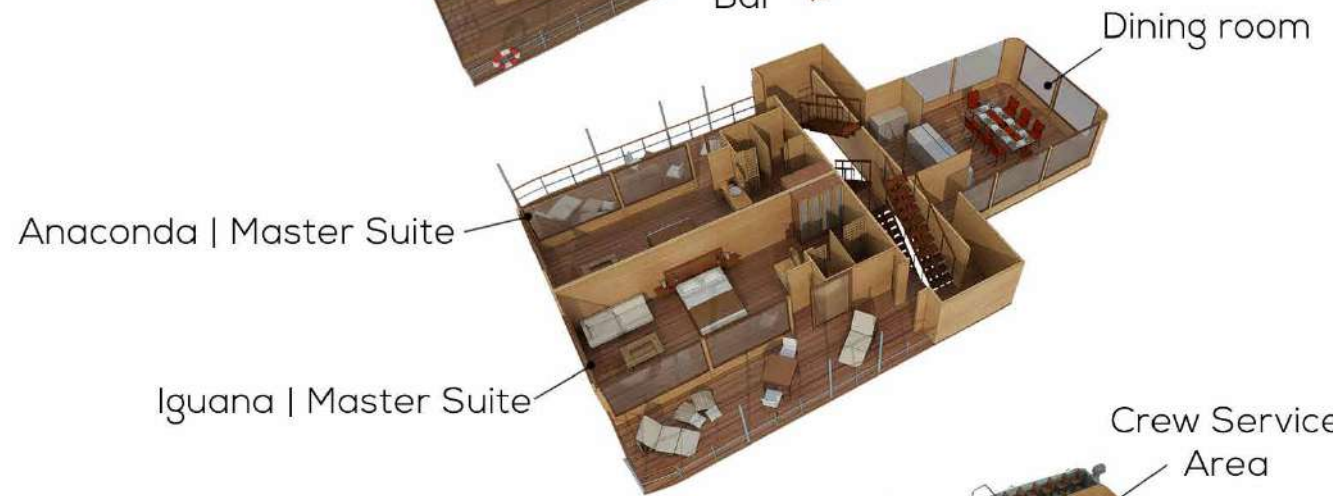

MAIN DECK
Cabins

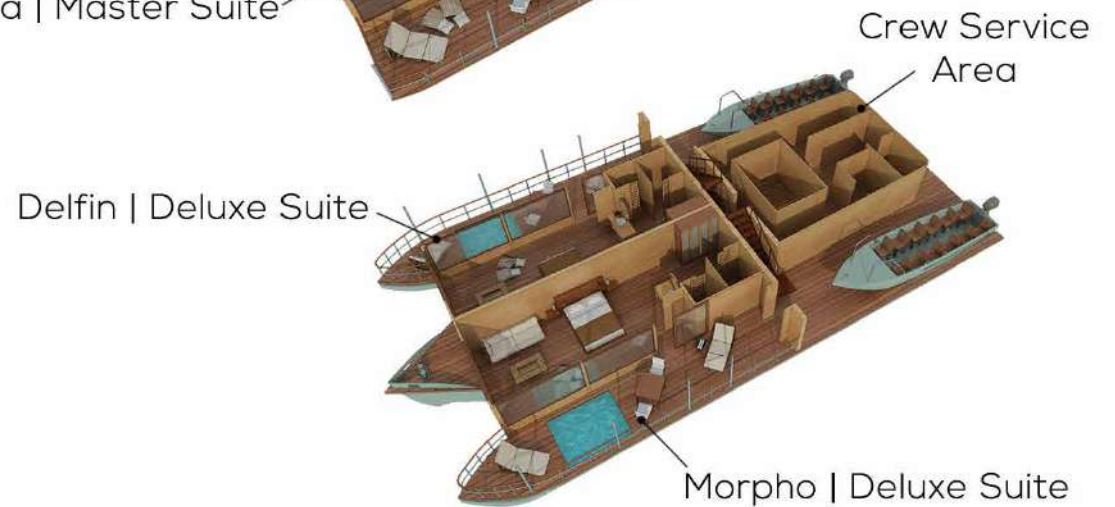



DELFIN I

- Latest updates: Refurbished in 2010
- Type of vessel: River vessel
- Port of embarkation: City of Nauta
- Vessel's Registry: Peru
- Length: 67 feet
- Beam: 33 feet
- Draft: 5'8"
- Capacity: 8 passengers / 12 passenger maximum
- Generator: Caterpillar, 45 W (encapsulated)
- Engine: Cummins 285HP diesel turbo boosted
- Cruising Speed: Average 8 knots
- Water: Water treatment plant with 5.0 cubic meter capacity
- Sewage Waters: 2.5 cubic meter septic tank
- Radio Communication: VHF, UHF and satellite phone on board
- Launch Boats: 2 aluminum 10 passenger skiffs equipped with four stroke low emission Mercury 60HP engines + radio communications with main vessel, life jackets and flares
- Life Jackets: one per passenger, available in each Suite

DECK PLAN DELFIN II

TOP OBSERVATION DECK

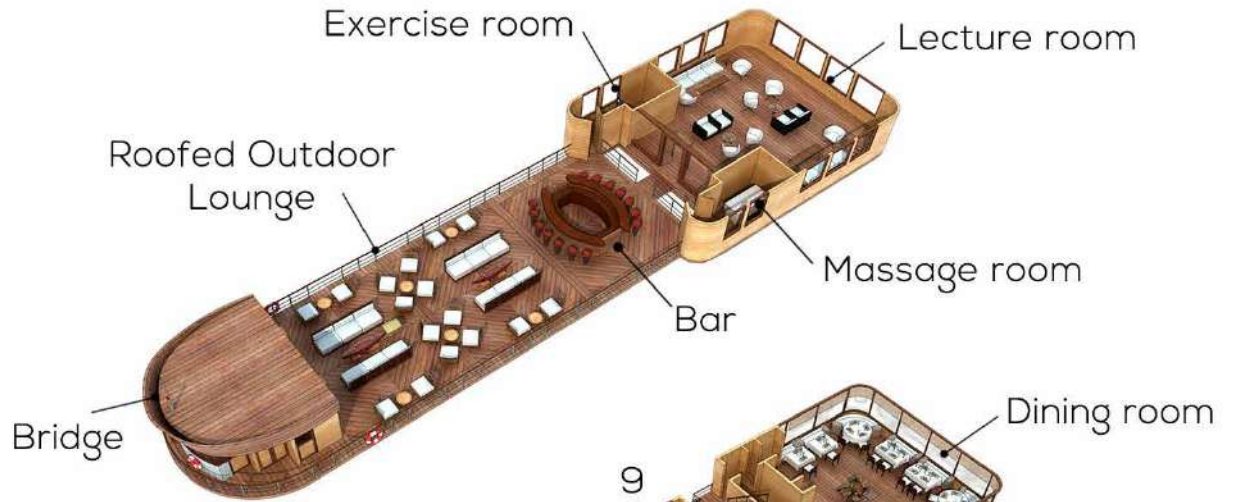

UPPER DECK

- 2 Master Suites (15, 16)
- 4 Suites (11, 12, 13, 14)
- 2 Tour conductor cabins* (9, 10)

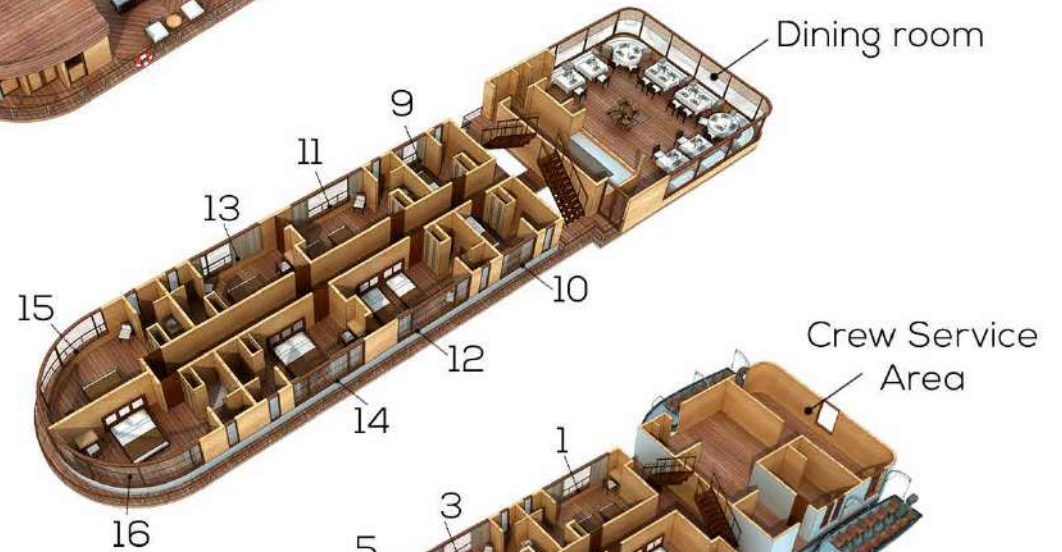

MAIN DECK

- 2 Master Suites (7, 8)
- 2 pairs of Interconnected Suites (3 - 5, 4 - 6)
- 2 Suites (1, 2)

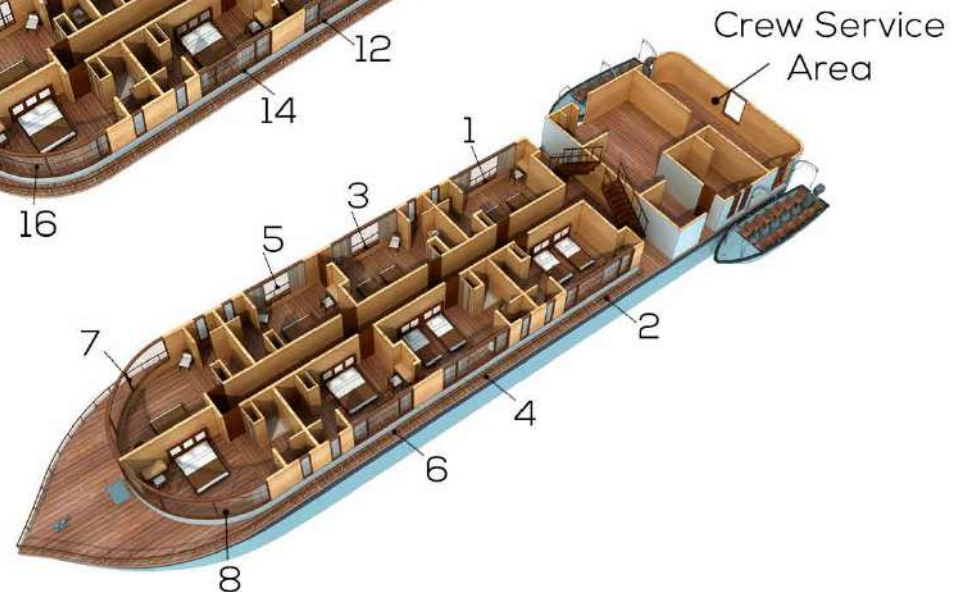

* Tour conductor cabin: For Delfin staff only.



DELFIN II

- Year built: 2009
- Type of vessel: River vessel
- Port of embarkation: City of Nauta
- Vessel's Registry: Peru
- Length: 135 feet
- Beam: 32 feet
- Draft: 8'25"
- Capacity: 28 passengers
- Generator: 2 Caterpillars, 55 KW (encapsulated)
- Engine: Caterpillar C12 385HP eco-electronic
- Cruising Speed: Average 8.20 knots
- Water: Water treatment plant with 7.0 cubic meter capacity
- Sewage Waters: Sewage treatment plant
- Radio Communication: VHF, UHF and satellite phone on board
- Launch Boats: 3 aluminum 10 passenger skiffs (+1 for emergencies with four stroke low emission Mercury 60HP engines + radio communications with main vessel, life jackets and flares.
- Life Jackets: one per passenger, available in each Suite

DECK PLAN DELFIN III

TOP OBSERVATION DECK



UPPER DECK

Owner's Suites (201)
10 Upper Suites (202 - 211)

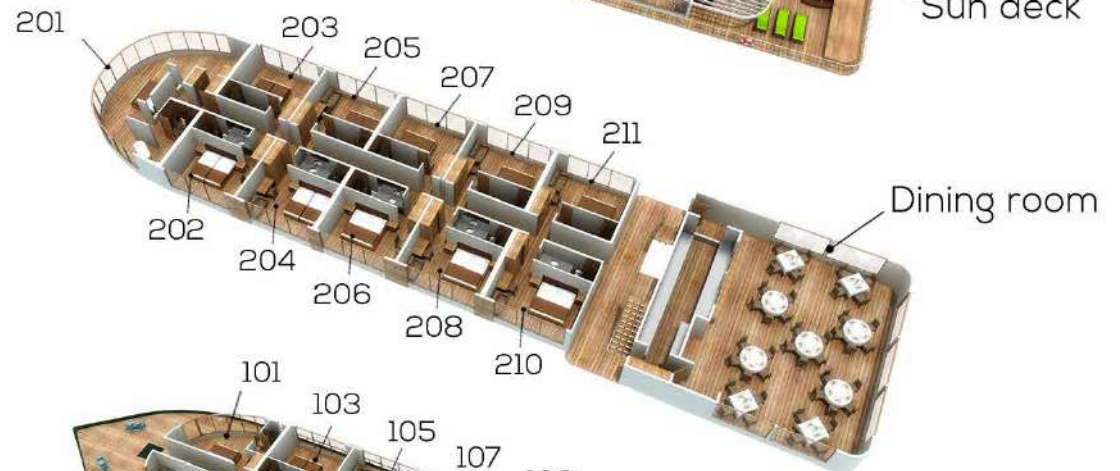

MAIN DECK

Corner Suites (101, 102)
Suites (103 - 111)
Tour conductor cabin* (112, 113)

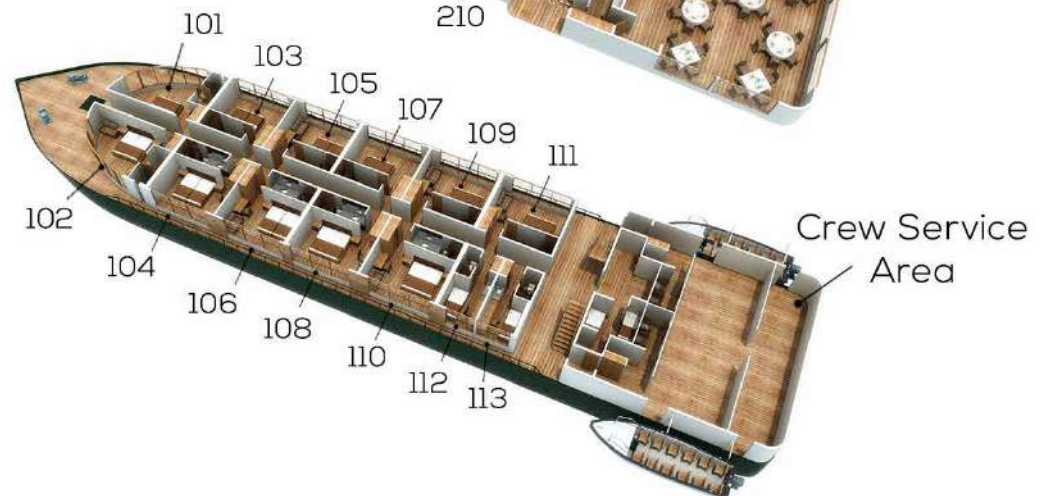

* Tour conductor cabin: For Delfin staff only.



DELFIN III

- Year built: 2015
- Type of vessel: River vessel
- Port of embarkation: City of Nauta
- Vessel's Registry: Peru
- Length: 168 feet
- Beam: 39 feet
- Draft: 4'92"
- Capacity: 44 passengers
- Generator: 2 Caterpillars, 120KW each
- Engine: Caterpillar C18 455HP
- Cruising Speed: Average 10 knots
- Water: Water treatment plant with 4 tanks (1,100 liters each one)
- Sewage Waters: Sewage treatment plant PTAR with 2 tanks
- Radio Communication: VHF-FM, HF, satellite trapping system NOVACAM/ SIMTRAC and satellite phone on board.
- Launch Boats: 3 aluminum 17 passenger skiffs (for emergencies with two motors Mercury 60 HP engine)
- Life Jackets: one per passenger, available in each Suite

RELAIS & CHÂTEAUX

Delfin Amazon Cruises, pioneer of upscale river cruising in the Upper Peruvian Amazon, becomes **the first cruise company to join Relais & Châteaux's iconic portfolio.**

Known for its strict admission standards, Relais & Châteaux members must fill the excellent criteria of the Association and encompass the following core values: local focus, humanity, sharing and commitment.

Delfin Amazon Cruises joins the prestigious collection having set the highest standards for impeccable service, stylish design and superb authentic cuisine, in one of the world's most fascinating and remote locations, the Amazon Basin. Relais & Châteaux members include over 550 world-class hotels and restaurants spanning the globe, each with a distinct setting, atmosphere and flavor.

"It is a true privilege and honor to become a member of Relais & Châteaux, a brand that is synonymous with quality and that champions the finest hospitality in unique places around the world," said Aldo Macchiavello, Founder and CEO of Delfin Amazon Cruises. "We are also proud to be recognized for our commitment to upholding the delicate balance at play in our pristine Amazon wilderness through our local community projects and sustainability efforts."

Aligned to Relais & Châteaux's mission to promote the richness and diversity of the world's cuisine and traditions of hospitality, Delfin prides itself on its world-class hospitality, combining authentic Peruvian gastronomy and understated luxury aboard uniquely designed vessels that allow guests to explore the Amazon in true style and comfort. The brand has a strong commitment to preserving the rich biodiversity of the Amazon rainforest and works closely with its non-profit partner, The Kuyapa Foundation, which supports local communities and strives to protect Amazonia's fragile ecosystem for generations to come.



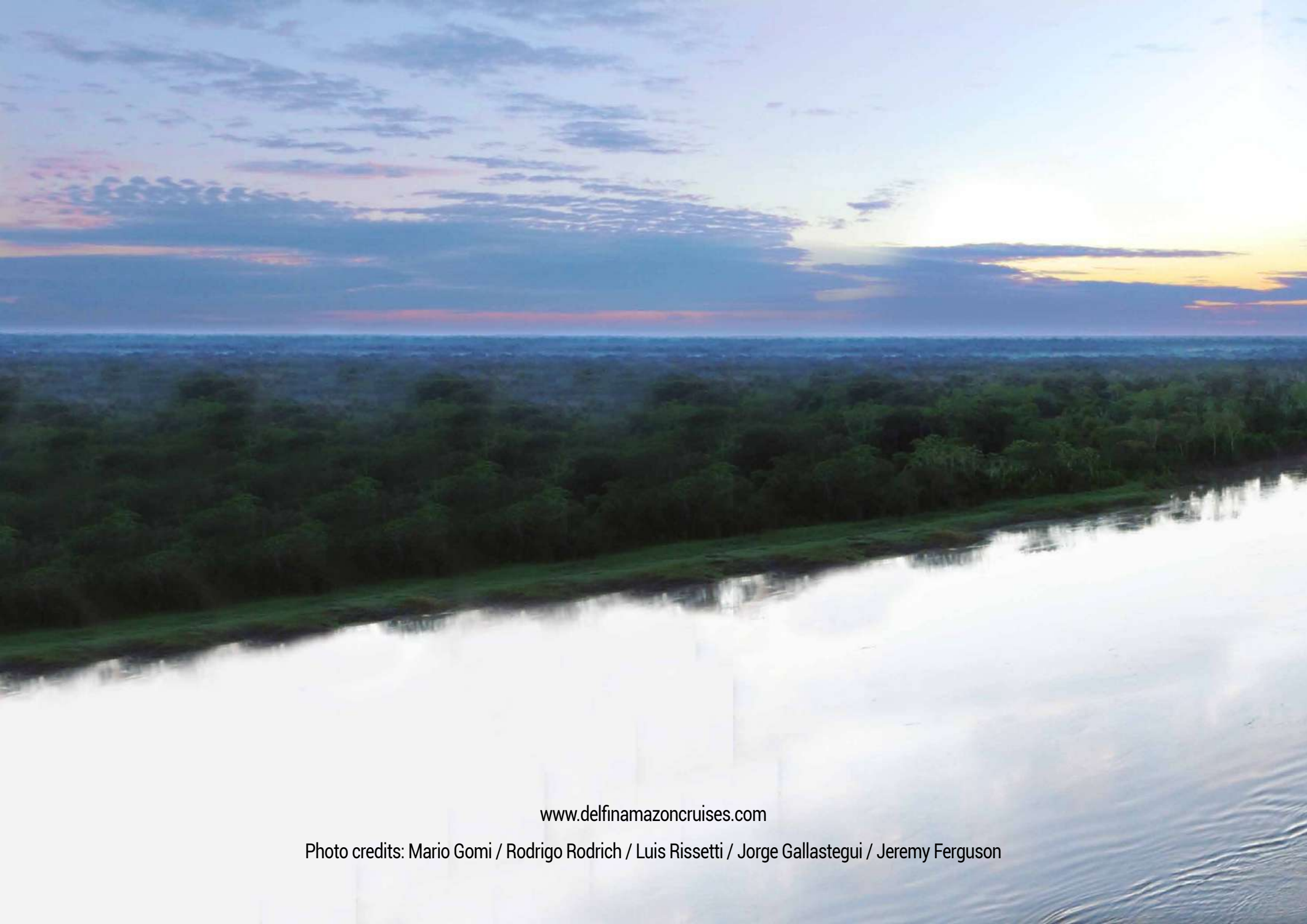

www.delfinamazoncruises.com

Photo credits: Mario Gomi / Rodrigo Rodrich / Luis Rissetti / Jorge Gallastegui / Jeremy Ferguson